



Electric Pistol Nutrunner

Product Instructions

Valid from Serial No. 25x00000xxxxx to 29x00000xxxxx

Model

EPD Series

Part number



Download the latest version of this document at
http://www.desouttertools.com/info/6159990780_EN

	⚠ WARNING
	<p>Read all safety warnings and instructions</p> <p>Failure to follow the safety warnings and instructions may result in electric shock, fire and/or serious injury.</p> <p>Save all warnings and instructions for future reference</p>

Table of Contents

Product Information	4
General Information.....	4
Safety Signal Words.....	4
Warranty.....	4
Website	4
Information about installation manuals.....	4
Information about spare parts	4
Dimensions (mm).....	5
CAD files	6
Overview	6
General overview	6
Product description	7
Technical data.....	7
Accessories.....	8
Installation	10
Installation Instructions	10
Connecting the tool to the controller	10
Installing the Side Handle	10
Installing the Reaction Bar	10
Installing the Suspension Assembly.....	11
Installing the Suspension Assembly for EB2/EB4.....	11
Installing the Suspension Assembly for EB6.....	12
Installing the barcode reader.....	12
Operation	13
Operating Instructions	13
Starting the tool	13
How to reverse the rotation	13
Tightening status and LED reporting.....	13
Service	15
Maintenance Instructions	15
Instructions for transducerized tools	15
Read before maintenance.....	15
Preventive Maintenance.....	15
Upgrading tools	15
Checking before putting back into service.....	15
Recommissioning	16

Table 0 - Applicable to below models:

Model	Part Number
EPD7-2080-4Q	6151662810
EPD7-2080-4Q-1	6151662820
EPD7-2080-4Q-5	6151662830
EPD7-2080-10S	6151662840
EPD7-2080-10S-1	6151662850
EPD7-2080-10S-5	6151662860
EPD10-1520-4Q	6151662870
EPD10-1520-4Q-1	6151662880
EPD10-1520-4Q-5	6151662890
EPD10-1520-10S	6151662900
EPD10-1520-10S-1	6151662910
EPD10-1520-10S-5	6151662920
EPD16-1120-4Q	6151662930
EPD16-1120-4Q-1	6151662940
EPD16-1120-4Q-5	6151662950
EPD16-1120-10S	6151662960
EPD16-1120-10S-1	6151662970
EPD16-1120-10S-5	6151662980
EPD20-1770-10S	6151662990
EPD20-1770-10S-1	6151663000
EPD20-1770-10S-5	6151663010
EPD27-1230-10S	6151663020
EPD27-1230-10S-1	6151663030
EPD27-1230-10S-5	6151663040
EPD40-1260-10S	6151663050
EPD40-1260-10S-1	6151663060
EPD40-1260-10S-5	6151663070
EPD70-850-SQ1/2	6151663080
EPD70-850-SQ1/2-1	6151663090
EPD70-850-SQ1/2-5	6151663100
EPD110-560-SQ1/2	6151663110
EPD110-560-SQ1/2-1	6151663120
EPD110-560-SQ1/2-5	6151663130

Product Information

General Information

WARNING Risk of Property Damage or Severe Injury

Ensure that you read, understand and follow all instructions before operating the tool. Failure to follow all the instructions may result in electric shock, fire, property damage and/or severe bodily injury.

- ▶ Read all Safety Information delivered together with the different parts of the system.
- ▶ Read all Product Instructions for installation, operation and maintenance of the different parts of the system.
- ▶ Read all locally legislated safety regulations regarding the system and parts thereof.
- ▶ Save all Safety Information and instructions for future reference.

Safety Signal Words

The safety signal words **Danger**, **Warning**, **Caution**, and **Notice** have the following meanings:

DANGER	DANGER indicates a hazardous situation which, if not avoided, will result in death or serious injury.
WARNING	WARNING indicates a hazardous situation which, if not avoided, could result in death or serious injury.
CAUTION	CAUTION, used with the safety alert symbol, indicates a hazardous situation which, if not avoided, could result in minor or moderate injury.
NOTICE	NOTICE is used to address practices not related to personal injury.

Warranty

- Product warranty will expire in 12+1 months after dispatch from Desoutter's Distribution Center.
- Normal wear and tear on parts is not included within the warranty.
 - Normal wear and tear is that which requires a part change or other adjustment/overhaul during standard tool maintenance typical for that period (expressed in time, operation hours or otherwise).
- The product warranty relies on the correct use, maintenance, and repair of the tool and its component parts.
- Damage to parts that occurs as a result of inadequate maintenance or performed by parties other than Desoutter or their Certified Service Partners during the warranty period is not covered by the warranty.
- To avoid damage or destruction of tool parts, service the tool according to the recommended maintenance schedules and follow the correct instructions.
- Warranty repairs are performed only in Desoutter workshops or by Certified Service Partners.

Desoutter offers extended warranty and state-of-the-art preventive maintenance through its Tool Care contracts. For further information, contact your local Service representative.

For electrical motors:

- Warranty will apply, only when the electric motor has not been opened.

Website

Information concerning our Products, Accessories, Spare Parts and Published Matters can be found on the Desoutter website.

Please visit: www.desouttertools.com.

Information about installation manuals

Detailed operating instructions, installation and upgrade manuals are available at <https://www.desouttertools.com/resource-centre>.

Information about spare parts

Exploded views and spare parts lists are available in Service Link at <https://www.desouttertools.com/resource-centre>.

Dimensions (mm)

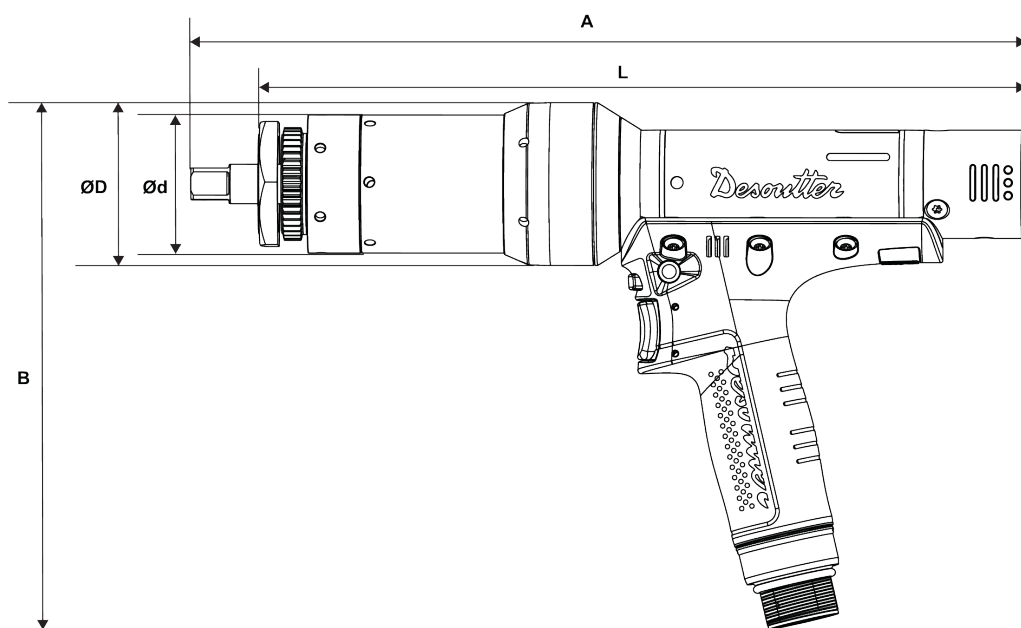
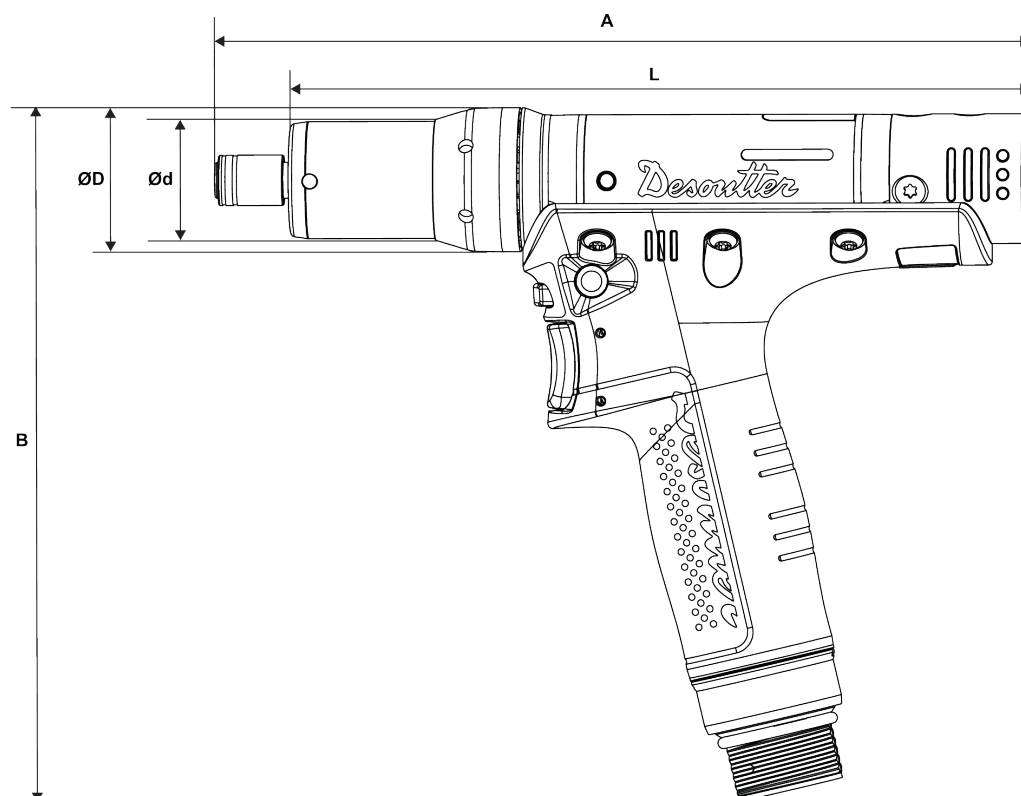

Model	A (mm)	L (mm)	B (mm)	Ød (mm)	ØD (mm)	Weight (kg)
EPD7-2080-4Q	227	205.5	191	32	40	0.9
EPD7-2080-4Q-1	256	234.5	195	32	40	1.2
EPD7-2080-4Q-5	256	234.5	195	32	40	1.85
EPD7-2080-10S	229	206	191	32	40	0.9
EPD7-2080-10S-1	258	235	195	32	40	1.2
EPD7-2080-10S-5	258	235	195	32	40	1.85

Product Information

Model	A (mm)	L (mm)	B (mm)	Ød (mm)	ØD (mm)	Weight (kg)
EPD10-1520-4Q	227	205.5	191	32	40	0.9
EPD10-1520-4Q-1	256	234.5	195	32	40	1.2
EPD10-1520-4Q-5	256	234.5	195	32	40	1.85
EPD10-1520-10S	229	206	191	32	40	0.9
EPD10-1520-10S-1	258	235	195	32	40	1.2
EPD10-1520-10S-5	258	235	195	32	40	1.85
EPD16-1120-4Q	227	205.5	191	32	40	0.9
EPD16-1120-4Q-1	256	234.5	195	32	40	1.2
EPD16-1120-4Q-5	256	234.5	195	32	40	1.85
EPD16-1120-10S	229	206	191	32	40	0.9
EPD16-1120-10S-1	258	235	195	32	40	1.2
EPD16-1120-10S-5	258	235	195	32	44	1.85
EPD20-1770-10S	245	222	203	36.5	44	1.1
EPD20-1770-10S-1	256	233	207	36.5	44	1.4
EPD20-1770-10S-5	256	233	207	36.5	44	2.05
EPD27-1230-10S	245	222	203	36.5	44	1.1
EPD27-1230-10S-1	256	233	207	36.5	44	1.4
EPD27-1230-10S-5	256	233	207	36.5	44	2.05
EPD40-1260-10S	298	275.5	210	48.5	58	1.95
EPD40-1260-10S-1	309	286.5	210	48.5	58	2.25
EPD40-1260-10S-5	309	286.5	210	48.5	58	2.85
EPD70-850-SQ1/2	298	275.5	210	48.5	58	1.95
EPD70-850-SQ1/2-1	309	286.5	214	48.5	58	2.25
EPD70-850-SQ1/2-5	309	286.5	214	48.5	58	2.85
EPD110-560-SQ1/2	339	311.5	214	56	66	2.7
EPD110-560-SQ1/2-1	350	322.5	218	56	66	3
EPD110-560-SQ1/2-5	350	322.5	218	56	66	3.65

CAD files

For information about the dimensions of a product, see the Dimensional drawings archive:

<https://www.desouttertools.com/resource-centre>

Overview

General overview

EPD are Electric Pistol Nutrunners powered by one of these Desoutter controllers.

Controller	Part number
CVI3 FUNCTION	6159326900
CVI3 VISION	6159326910
CVI3 FUNCTION E-STOP	6159326930
CVI3 VISION E-STOP	6159326940
CVI3 ESSENTIAL	6159326950
TWINCVI3	6159326970
TWINCVI3 E-STOP	6159326980

They are hand-held by the operator.

They can also be used as fixtured tools and installed on a frame in the workstation.

Contact your Desoutter representative to get more information and support.

They receive the tightening process instructions from the controller.

Tool settings, such as buzzer, vibrator, and LED management, can be configured with CVI CONFIG.

All models are equipped with the eCompass feature.

This feature is available for tools with a gyroscope. It compensates for any operator movement that might change the assembly angle. An angle range (tool angle limits) is set to stop tightening if the operator's movement is outside this range. This feature is programmable with CVI CONFIG software. The ePOD model (ePOD2 Compass) must be connected to the controller.

Product description

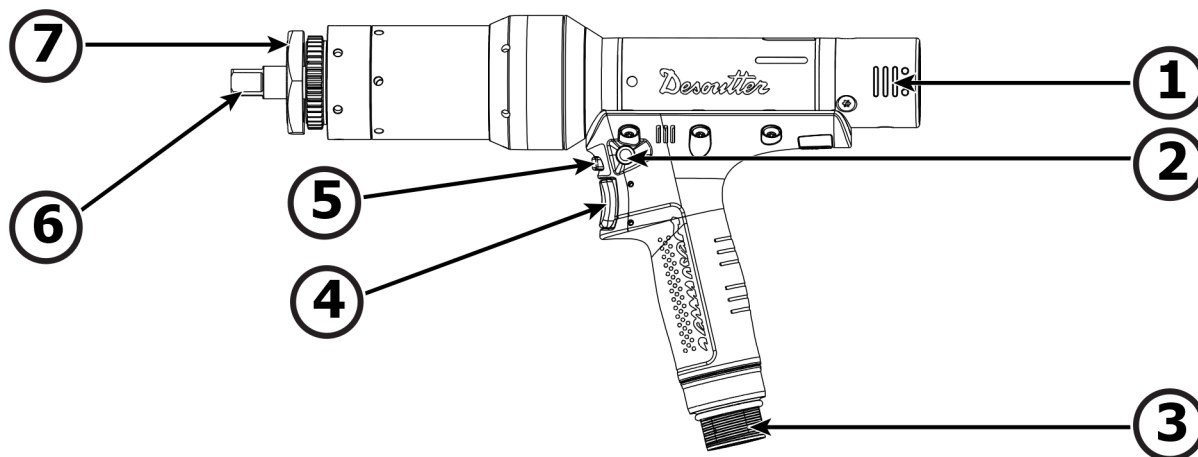

	Description
1	Reporting LEDs
2	Reverse button
3	Connector
4	Trigger
5	Function button
6	Output drive
7	Front light and reporting LEDs

Technical data

Model	A (inch)	L (inch)	B (inch)	Ød (inch)	ØD (inch)	Weight (lbs)
EPD7-2080-4Q	8.9	8.1	7.5	1.3	1.6	2.0
EPD7-2080-4Q-1	10.1	9.2	7.7	1.3	1.6	2.6
EPD7-2080-4Q-5	10.1	9.2	7.7	1.3	1.6	4.1
EPD7-2080-10S	9.0	8.1	7.5	1.3	1.6	2.0
EPD7-2080-10S-1	10.2	9.3	7.7	1.3	1.6	2.6
EPD7-2080-10S-5	10.2	9.3	7.7	1.3	1.6	4.1
EPD10-1520-4Q	8.9	8.1	7.5	1.3	1.6	2.0
EPD10-1520-4Q-1	10.1	9.2	7.7	1.3	1.6	2.6
EPD10-1520-4Q-5	10.1	9.2	7.7	1.3	1.6	4.1
EPD10-1520-10S	9.0	8.1	7.5	1.3	1.6	2.0
EPD10-1520-10S-1	10.2	9.3	7.7	1.3	1.6	2.6
EPD10-1520-10S-5	10.2	9.3	7.7	1.3	1.6	4.1
EPD16-1120-4Q	8.9	8.1	7.5	1.3	1.6	2.0
EPD16-1120-4Q-1	10.1	9.2	7.7	1.3	1.6	2.6
EPD16-1120-4Q-5	10.1	9.2	7.7	1.3	1.6	4.1
EPD16-1120-10S	9.0	8.1	7.5	1.3	1.6	2.0
EPD16-1120-10S-1	10.2	9.3	7.7	1.3	1.6	2.6
EPD16-1120-10S-5	10.2	9.3	7.7	1.3	1.7	4.1

Product Information

Model	A (inch)	L (inch)	B (inch)	Ød (inch)	ØD (inch)	Weight (lbs)
EPD20-1770-10S	9.6	8.7	8.0	1.4	1.7	2.4
EPD20-1770-10S-1	10.1	9.2	8.1	1.4	1.7	3.1
EPD20-1770-10S-5	10.1	9.2	8.1	1.4	1.7	4.5
EPD27-1230-10S	9.6	8.7	8.0	1.4	1.7	2.4
EPD27-1230-10S-1	10.1	9.2	8.1	1.4	1.7	3.1
EPD27-1230-10S-5	10.1	9.2	8.1	1.4	1.7	4.5
EPD40-1260-10S	11.7	10.8	8.3	1.9	2.3	4.3
EPD40-1260-10S-1	12.2	11.3	8.3	1.9	2.3	5.0
EPD40-1260-10S-5	12.2	11.3	8.3	1.9	2.3	6.3
EPD70-850-SQ1/2	11.7	10.8	8.3	1.9	2.3	4.3
EPD70-850-SQ1/2-1	12.2	11.3	8.4	1.9	2.3	5.0
EPD70-850-SQ1/2-5	12.2	11.3	8.4	1.9	2.3	6.3
EPD110-560-SQ1/2	13.3	12.3	8.4	2.2	2.6	6.0
EPD110-560-SQ1/2-1	13.8	12.7	8.6	2.2	2.6	6.6
EPD110-560-SQ1/2-5	13.8	12.7	8.6	2.2	2.6	8.0

Storage and use conditions

Storage temperature	-20 °C to +70 °C (-4 °F to +158 °F)
Operating temperature	0 °C to 45 °C (32 °F to 113 °F)
Storage humidity	0-95 % RH (non-condensing)
Operating humidity	0-90 % RH (non-condensing)
Altitude up to	2000 m (6562 feet)
Usable in Pollution degree 2 environment	
Indoor use only	

Accessories

Optional Accessories

- Side handle

Model	Part number	Comments
Side handle assy	6154012820	For EPD7, EPD10, EPD16
Side handle assy	467033	For EPD20, EPD27

- Suspension

Model	Part number	Comments
Suspension Swivel	6154012830	For EPD7, EPD10, EPD16
Suspension Swivel	6154012840	For EPD20, EPD27
Suspension Swivel	6154012860	For EPD40, EPD70
Suspension Swivel	6154012870	For EPD110
Suspension	467003	For EPD7, EP10, EPD16, EPD20, EPD27 Not authorized for EPD40, EPD70, EPD110

- Reaction bars

Model	Part number	Comments
Reaction Bar Straight	6158120545	For EPD40, EPD70, EPD110
Reaction Bar S-Type	6158120695	For EPD40, EPD70, EPD110

Model	Part number	Comments
Reaction Bar Sliding Drive	6158120625	For EPD40, EPD70, EPD110
Reaction Bar L-Type Aluminum	6158120735	For EPD40, EPD70, EPD110
Reaction Bar Sliding Drive	6158120635	For EPD40, EPD70, EPD110
Reaction Bar Square	6158120585	For EPD40, EPD70, EPD110

For EPD7/10/16/20/27, contact your Desoutter representative for more information and support.

- Barcode reader

SCAN2D-P2LRT	6158137000	For EPD7, EPD10, EPD16
SCAN2D-P4LRT	6158137010	For EPD20, EPD27, EPD40, EPD70, EPD110

- Plastic covers

PLASTIC COVER EPD7/10/16/LRT25	6152112140	Included with tool - For EPD7/10/16 bottom cable
PLASTIC COVER EPD20/27	6152112150	Included with tool - For EPD20/27 bottom cable
PLASTIC COVER EPD40/70	6152112170	Optional - For EPD40/70 bottom cable
PLASTIC COVER EPD110	6152112180	Optional - For EPD110 bottom cable
PLASTIC COVER EPD7/10/16/LRT25 TC	6152112190	Included with tool - For EPD7/10/16 top cable
PLASTIC COVER EPD20/27 TC	6152112200	Included with tool - For EPD20/27 top cable
PLASTIC COVER EPD40/70 TC	6152112220	Optional - For EPD40/70 top cable
PLASTIC COVER EPD110 TC	6152112230	Optional - For EPD110 top cable

Required Accessories

- Tool cable

Part number	Length (ft)	Length (m)
6159178350	8.20	2.5
6159178360	16.0	5
6159178370	32.8	10
6159178380	49.2	15

- Extension

Part number	Length (ft)	Length (m)
6159175810	26.8	8
6159175840	52.5	16
6159175870	105	32

Installation

Installation Instructions

Connecting the tool to the controller

1. Connect the cable to the tool.
i Do not tighten the nut too much.
2. Connect the cable to the controller.

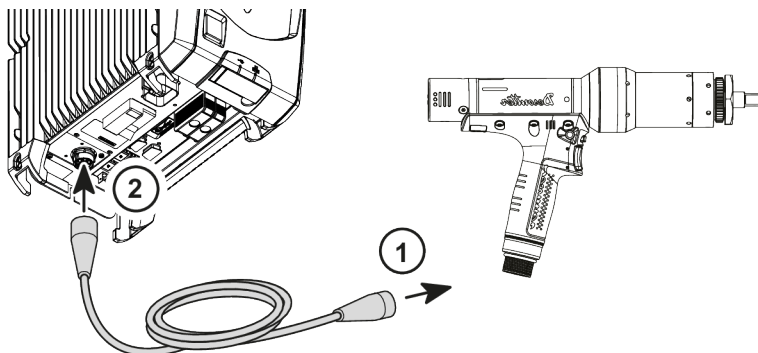

Installing the Side Handle

1. Hold the tool (2) properly.
2. Install the side handle (1).
3. Make sure the side handle is installed properly.

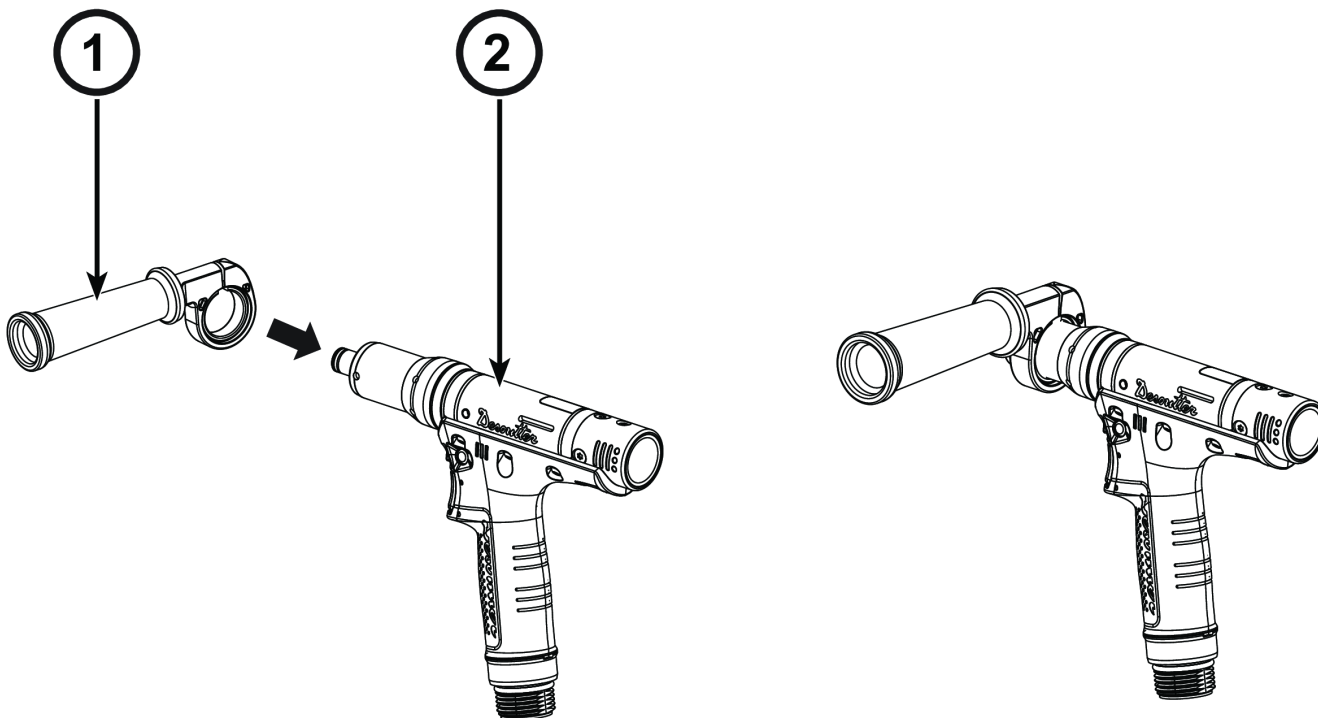

Installing the Reaction Bar

1. Remove the nut (1).
2. Position the reaction bar (2).
3. Install the reaction bar (2) onto the tool (3).
4. Tighten the nut (1).

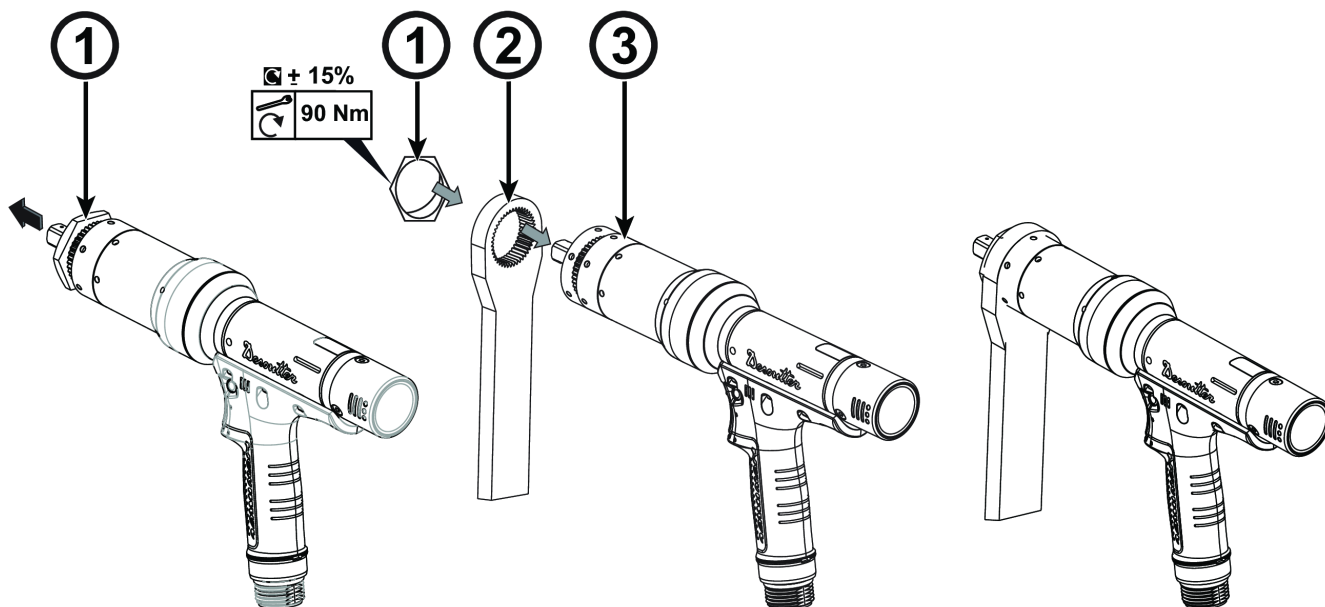

Installing the Suspension Assembly

1. Hold the tool (2) properly.
2. Install the suspension assembly (1).

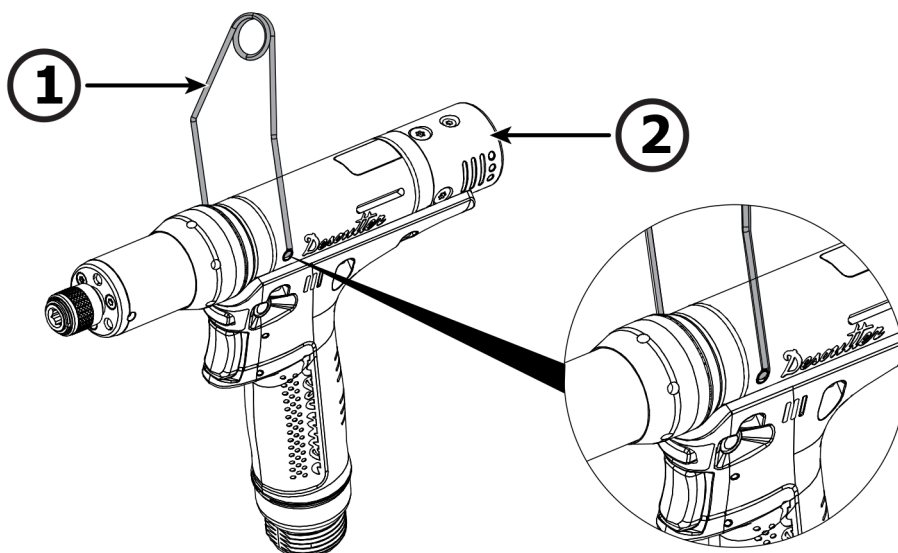

Installing the Suspension Assembly for EB2/EB4

1. Hold the tool (3) correctly.
2. Remove the nut (1) from the tool.
3. Install the suspension assembly (2) onto the tool (1).
4. Install the nut (1) onto the suspension assembly (2).

The tool is now ready to use.

Installation

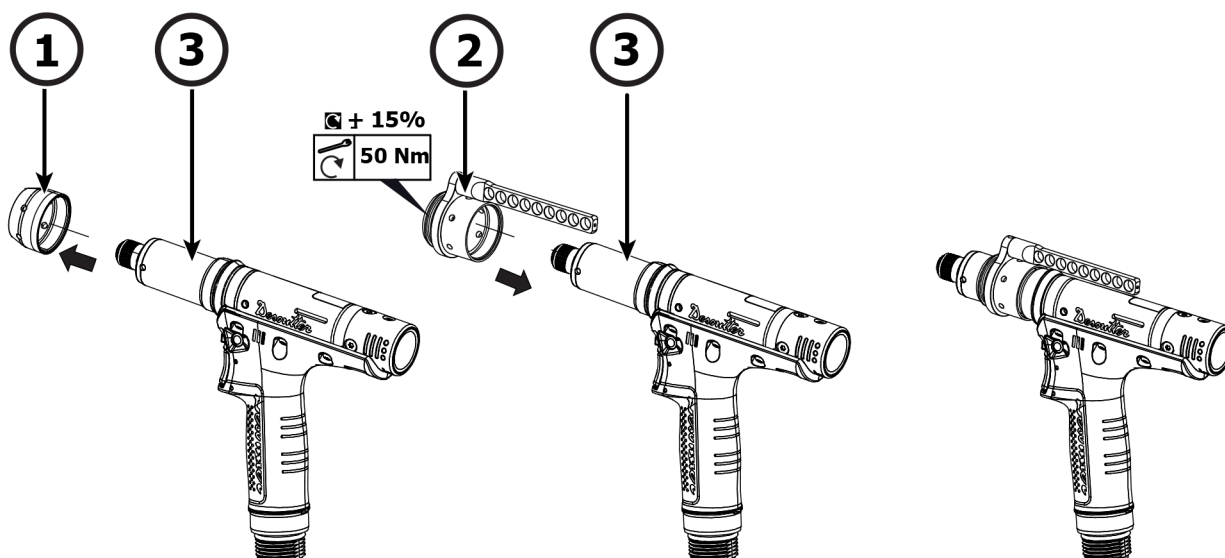

Installing the Suspension Assembly for EB6

1. Hold the tool properly.
2. Install the collet (2) using the allen bolt (1) onto the tool.
3. Install the suspension assembly (3) onto the tool.
4. Install the lock ring (4) onto the tool.

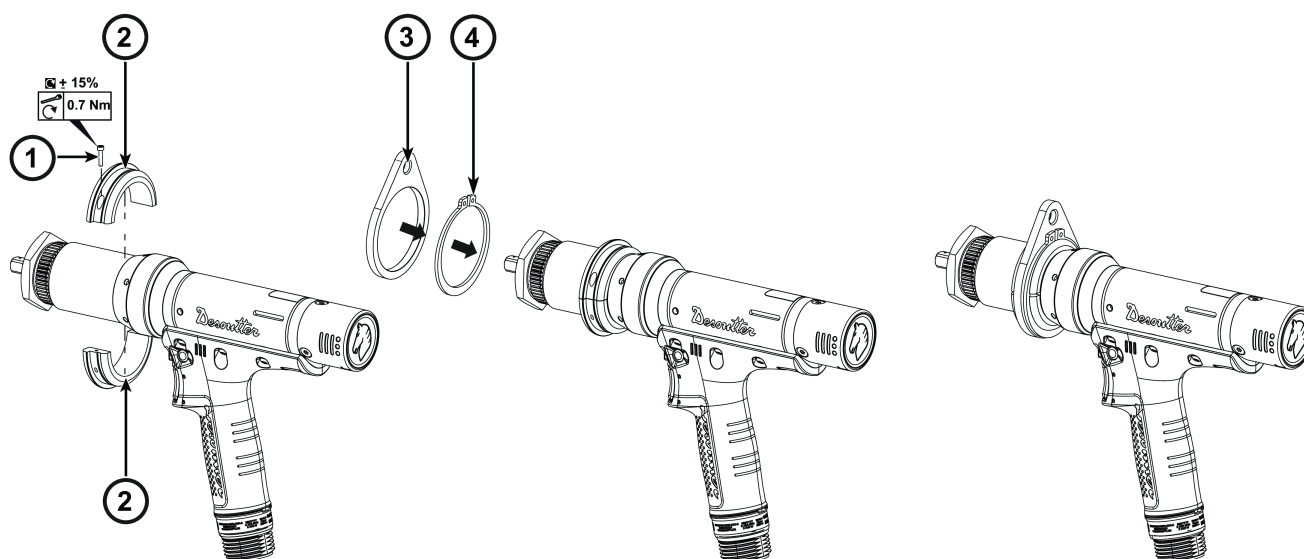

Installing the barcode reader

Refer to the Safety Information (6159990230) to the accessory available at <https://www.desouttertools.com/resource-centre>

Operation

Operating Instructions

Starting the tool

WARNING Risk Of Injury

As the reaction force increases in proportion to the tightening torque, there is a risk of severe bodily injury to the operator because of the unexpected behavior of the tool.

- ▶ Make sure that the tool is in perfect working order and that the system is programmed correctly.

1. Fit the tool with a suitable socket.
2. Select the appropriate program on the controller.
3. Hold the tool by the handle and apply it to the fastener to be tightened.
4. Press the trigger to start the tool.

How to reverse the rotation

Press the reverse button.

- Red and green reporting LEDs will blink alternately at the rear of the tool.
- Apply the tool to the fastener and press the trigger.

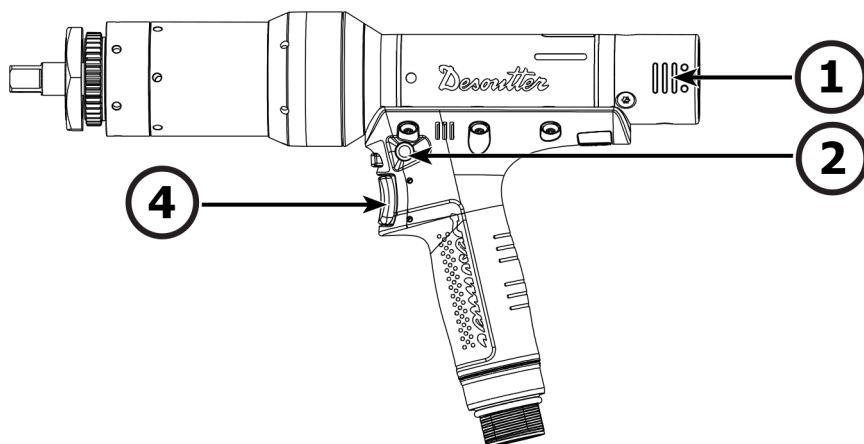

Tightening status and LED reporting

Reporting LEDs

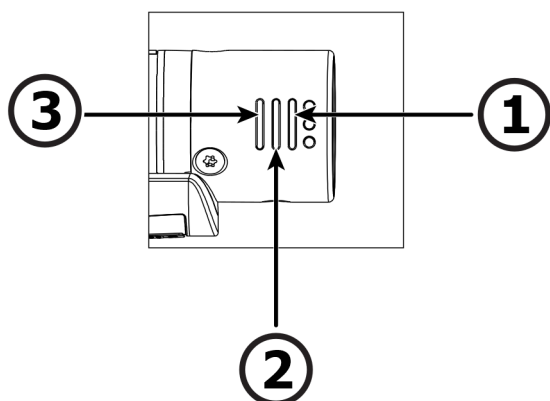

1	Yellow
2	Green
3	Red

Operation

How to read the tightening report

LED color	Description	Action to do
Green	Accept report	None
Yellow	Incomplete rundown	Tighten again.
Yellow and red (orange)	Reject report	Loosen and tighten again.
Red	Above max. limits	Loosen, replace the fastener and tighten again.

Service

Maintenance Instructions

Instructions for transducerized tools

- Do not damage the wires when pulling out the connectors.
- Do not pull out the torque transducer wires.
- Make sure that wires are not crushed.

Read before maintenance

WARNING Connection Hazard

The tool can start unexpectedly and cause severe bodily injury.

- ▶ Prior to any maintenance task, disconnect the tool.

Maintenance should be performed by **qualified personnel only**.

Follow standard engineering practices and refer to exploded views for disassembling and reassembling the different parts of the system.

Take into account the following instructions given in the exploded views.

Be cautious: when reassembling, tighten in the right direction.



Left hand thread



Right hand thread

When reassembling:



Apply the recommended glue.



Tighten to the required torque.



Lubricate with the required grease or oil. Do not apply too much grease on gears or bearings; a thin coat is sufficient.

Preventive Maintenance

Recommendations

Overhaul and preventive maintenance are recommended at regular intervals once per year or after a maximum number of tightenings (refer to the table below) depending on which occurs sooner.

Heavy duty

Heavy duty use can require more frequent overhaul and Preventive Maintenance intervals. Please contact your local Desoutter Service team to get a customized maintenance plan.

Upgrading tools

To upgrade tools, it is necessary to have:

- an ACCESS KEY USB stick set with the right profile.
This USB stick is provided by your CVIKEY manager.
- CVIMONITOR software

Contact your Desoutter representative to get more information and support.

Checking before putting back into service

Prior to putting the equipment back into service, check that its main settings have not been modified and that the safety devices work properly.

Recommissioning

Prior to putting the different parts of the system back into service, check that the main settings have been correctly set up and that the safety devices work properly.

Original instructions

Founded in 1914 and headquartered in France, Desoutter Industrial Tools is a global leader in electric and pneumatic assembly tools serving a wide range of assembly and manufacturing operations, including Aerospace, Automotive, Light and Heavy Vehicles, Off-Road, General Industry.

Desoutter offers a comprehensive range of Solutions -tools, service and projects- to meet the specific demands of local and global customers in over 170 countries.

The company designs, develops and delivers innovative quality industrial tool solutions, including Air and Electric Screwdrivers, Advanced Assembly Tools, Advanced Drilling Units, Air Motors and Torque Measurement Systems.

Find more on www.desouttertools.com



More Than Productivity