

ePOD

ePOD1	6159360750
ePOD2	6159360760
ePOD3	6159360770
ePOD2C	6159363110
ePOD3C	6159363180
ePOD4C	6159363120
ePOD customer	615936XXX0

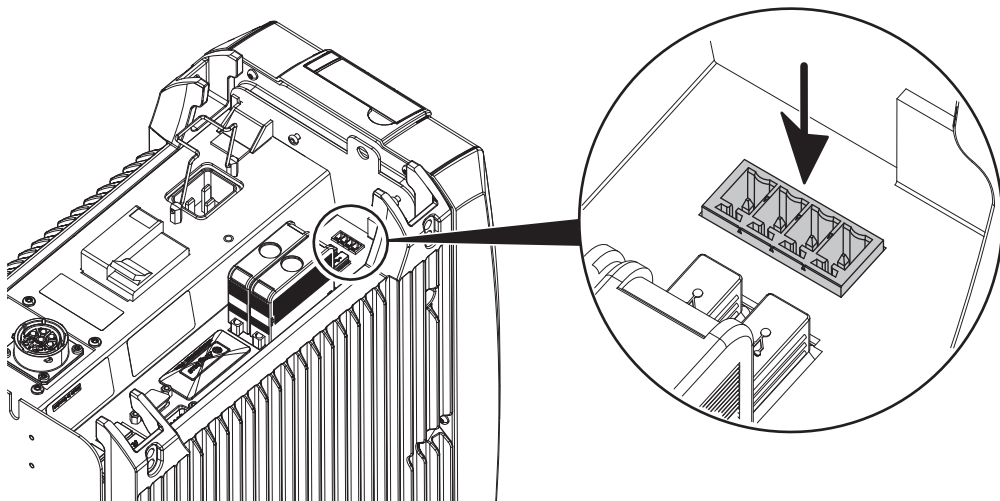
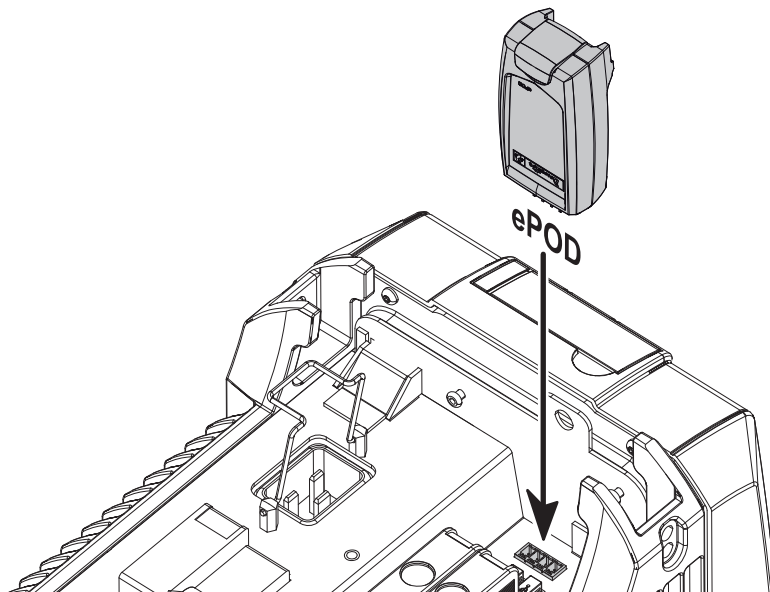

A

B

C

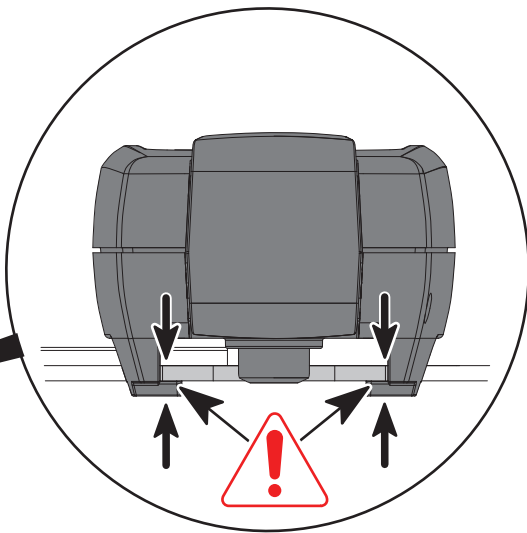
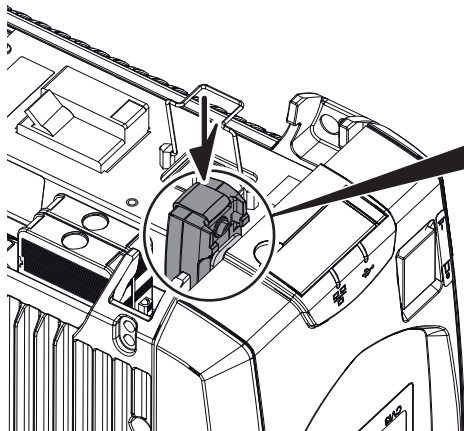

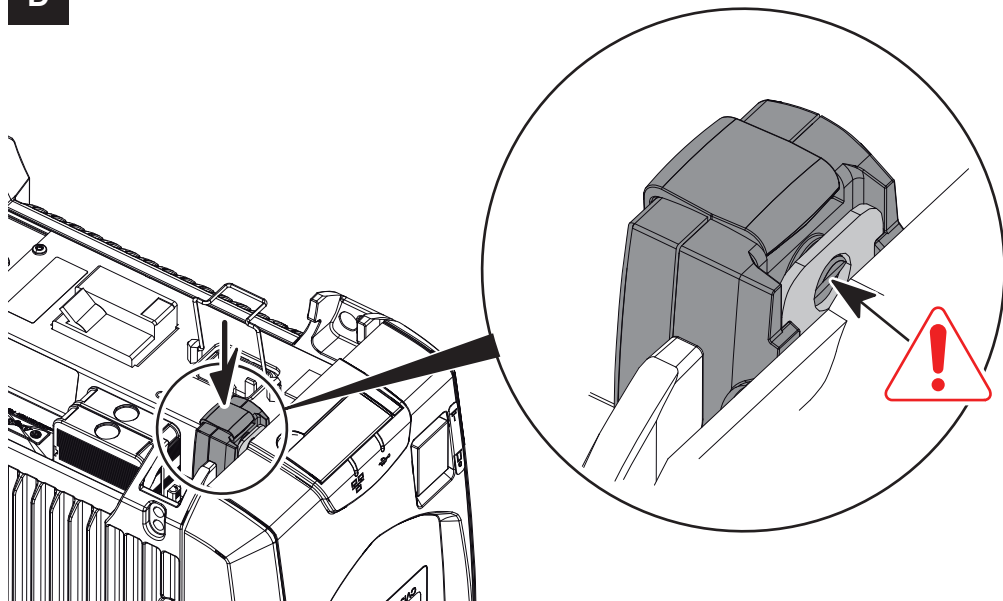
D

E

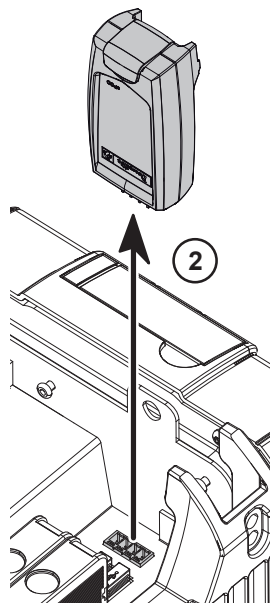
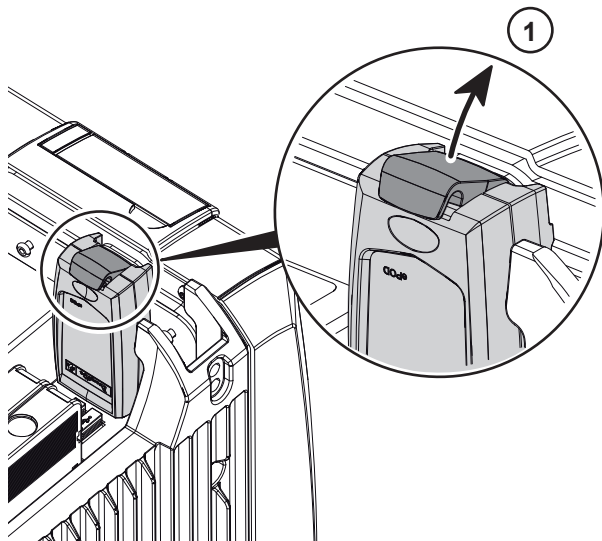

Name and content of harmful substances in products

产品中有害物质的名称及含量

部件名称	有毒有害物质或元素					
	铅(Pb)	汞 (Hg)	镉 (Cd)	六价铬 (Cr(VI))	多溴联苯 (PBB)	多溴二苯醚 (PBDE)
电子组件/ Electronics Module	x	o	o	o	o	o
外壳 / Housing	o	o	o	o	o	o
<p>本表格依据SJ/T11364的规定编制</p> <p>○：表示该有毒有害物质在该部件所有均质材料中的含量均在GB/T 26572 规定的限量要求以下。</p> <p>×：表示该有毒有害物质至少在该部件的某一均质材料中的含量超出GB/T 26572标准规定的限量要求。</p>						

More Than Productivity



www.desouttertools.com

© Copyright 2017